

SYSTEM NAME

The Skyline system is the flagship of the Rollease product line. The Skyline System offers a sleek profile with quiet solutions ideal for both residential & commercial applications.

AESTHETIC FEATURES

- Minimal light gaps
- Color coded brackets and covers

ASSEMBLY / PRODUCTION FEATURES

- Greater flexibility in installation with spring loaded pin end
- Crown, drive and adapters available to suit variety of tube sizes
- Works with all current Rollease hardware systems

FUNCTIONAL BENEFITS

- Internal spring arrangement ensures remarkably smooth operation
- Spring loaded end plugs are forgiving in installation
- Hooks on clutches ensure very fast installation
- Long-lasting product with limited life time warranty
- Exterior versions available

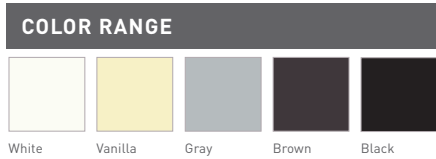
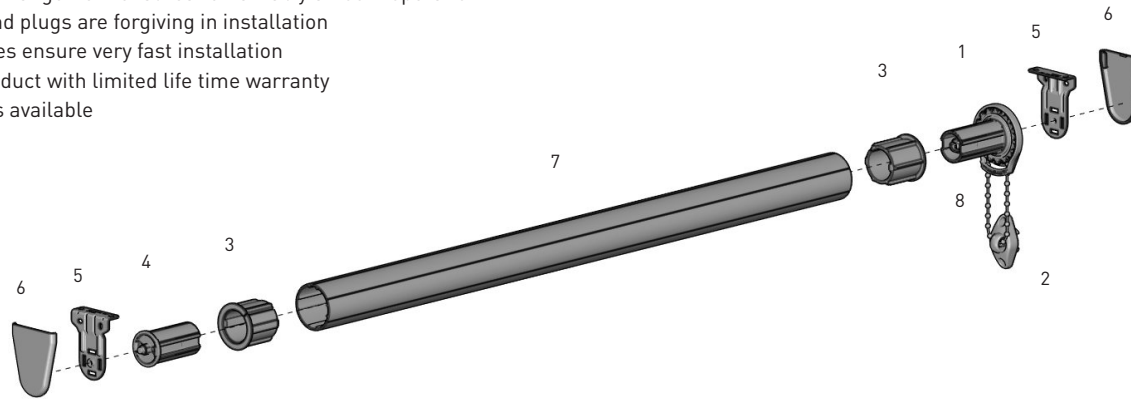

SYSTEM INDEX

1	Skyline Clutch SL##H##xx
2	Chain RBC45Mxx - Metal RBC6MMxx - Plastic
3	Skyline Adapter SLA##xx RA2##xx
4	Skyline Pin End SLPEHD53xx SLPEV####xx SLPE4##xx
5	Skyline Bracket SLB6##xx Standard SLBN6##xx Narrow
6	Skyline Bracket Cover SLBC##xx Standard SLNBC##xx Narrow
7	Aluminium Tube RTEA#T16
8	Tension / Hold Down Devices RE0051203 RB91-1336-xxx000 + RB91-1337-xxx000

- Size
xxx- Color

PRODUCT OPTIONS

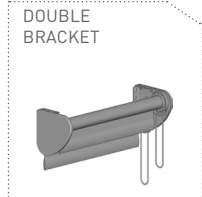
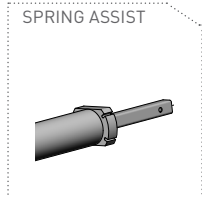
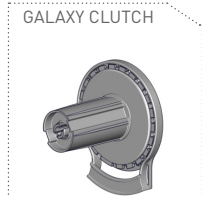

SYSTEM UPGRADES

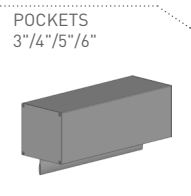
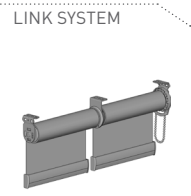

OTHER CONTROL OPTIONS



SPECIFICATIONS

DEDUCTION TABLE

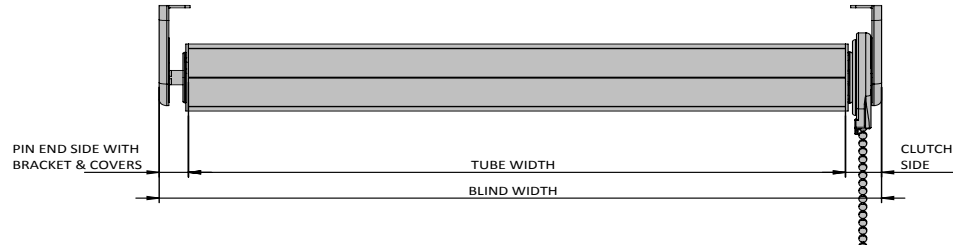

	PIN ENDS			PER COVER	PER BRACKET		ADAPTERS		
	CLUTCH SIDE	PIN END SIDE	HD PIN END	BRACKET COVER	SLB6xxxx	SLNB6xxxx	SLA4xxx	RA25xx	Other*
SL5/SL20	.45" [12mm]	.30" [8mm]	.33" [9mm]	.7" [2mm]	.19" [5mm]	.18" [5mm]	.06" [2mm]	.03" [1mm]	.00" [0mm]
SL10/SL15	.38" [10mm]	.30" [8mm]	.33" [9mm]	.7" [2mm]	.19" [5mm]	.18" [5mm]	.06" [2mm]	.03" [1mm]	.00" [0mm]
SL30	.50" [13mm]	.30" [8mm]	.33" [9mm]	.7" [2mm]	.19" [5mm]	.18" [5mm]	.06" [2mm]	.03" [1mm]	.00" [0mm]
G200	.56" [15mm]	.30" [8mm]	.33" [9mm]	.7" [2mm]	.19" [5mm]	.18" [5mm]	.06" [2mm]	.03" [1mm]	.00" [0mm]
G400	.50" [13mm]	.30" [8mm]	.33" [9mm]	.7" [2mm]	.19" [5mm]	.18" [5mm]	.06" [2mm]	.03" [1mm]	.00" [0mm]

These deductions allow an easy and quick installation (instal the pin end first, then the clutch side)

*All other adapters require no further deductions

MAX HOLD CAPACITY

CLUTCH	LOAD	TUBE	CORD or BEAD CHAIN
SL5	5.6lbs (2.5kg)	1" [25mm]	Both
SL10	11 lbs (5.0kg)	1½" [28mm]	Both
SL15	16.5 lbs (7.5kg)	1½" [28mm]	Both
SL15	12 lbs (5.5kg)	1½" [38mm]	Both
SL20	20 lbs (9.1kg)	1½" [38mm]	Bead
SL20	15 lbs (6.8kg)	2" [50mm]	Bead
SL30	22 lbs (10.0kg)	2" [50mm]	Bead
SL30	18 lbs (8.2kg)	2½" [63mm]	Bead
SL30	14.4 lbs (6.5kg)	3¼" [83mm]	Bead
G200	24 lbs (10.9kg)	1½" [38mm]	Bead
G200	18 lbs (8.2kg)	2" [50mm]	Bead
G200	14.4 lbs (6.5kg)	2½" [63mm]	Bead
G400	40 lbs (18.2kg)	2" [50mm]	Bead
G400	32 lbs (14.5kg)	2½" [63mm]	Bead
G400	25lbs (11.4kg)	3¼" [83mm]	Bead

Please note that the loads are max loads for clutches. Max loads will not produce comfortable pull forces.

TUBE ADAPTER COMPATIBILITY CHART

CLUTCH/TUBE	1" [25mm]	1-1/8" [28mm]	1-1/4" [32mm]	40mm	43mm	1-1/2" [38mm]	2" [50mm]	2-1/2" [63mm]	3-1/4" [83mm]
SL5/SL10	Compatible	Compatible	SLA03x	SLA04x	SLA43x	SLA53x	-	-	-
SL15	-	Compatible	SLA03x	SLA04x	SLA43x	SLA53x	-	-	-
SL20/G200	-	-	-	-	-	Compatible	RA2	RA25	-
SL30/G400	-	-	-	-	-	Compatible	RA2	RA25	RA25

MAX ROLL

BRACKET	MAX ROLL SIZE	SL5/SL10	SL15/SL20/G200	SL30/G400
SLNBxx650xx	2.35" [59.0mm]	Compatible	-	-
SLxx660xx	3" [76.2mm]	Compatible	Compatible	-
SLxx680xx	4" [101.6mm]	Compatible	Compatible	Compatible
SLxx690xx	5" [127.5mm]	Compatible	Compatible	Compatible

